

NEXTGEN

INSTALL-TOOLS: MOUNT-ZST-BL MOUNTING BRACKET

- This mounting bracket can be used to mount the NEXTGEN lightline system.
- With this bracket the lightline can be mounted directly to the ceiling. It can also be suspended using a threaded rod or chain.
- An M8 threaded rod fits into the mounting hole.
- The bracket is electrolytically galvanized.
- The insert is made of EPDM and is therefore age-resistant.



DC

DD

XC

XD

Features

artikel nr.: LUM-NG-60-MOUNT-ZST-BL

Dimensions (LxWxH)	75 mm x 20 mm x 80 mm
Inner diameter (D)	ø60 mm
Diameter mounting hole	M8
Weight	84 g
Material	Galvanized steel / EPDM
Temperature range	-40 °C - +110 °C

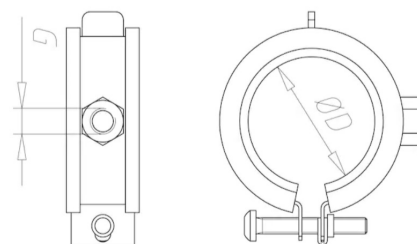

Mounting examples

