

## IQ TRONICS: PRESENCE DETECTION HIGHBAY PIR SENSOR

- With this presence detector, the light switches on when presence is detected. This enables maximized power savings, without compromising the ease of use of the DATALUX light system.
- This Tronic can be integrated with DATALUX.IQ, DATALUX.LT and DATALUX.AC lighting systems.
- The switching direction of the sensor can be set separately, so one can choose to power one side constantly and the other side switching on the sensor.
- With the standby setting, you can choose to switch off lighting or reduce light output to 10% when no detection takes place. This setting can be set separately on both sides of the sensor.

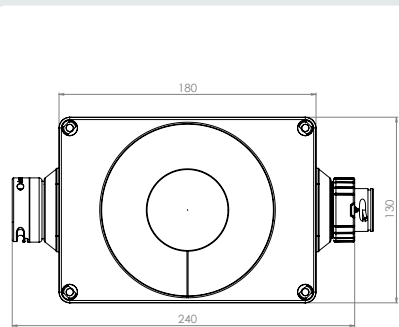

### Feature

Input voltage	220 - 240 V <sub>AC</sub> , 50/60 Hz
Input power	1 Watt
Type of sensor	PIR by Steinel
Suspension height	4-14 meters
Dimensions (lxwxh)	180 x 130 x 130 mm
Time interval	5 sec. - 15 min.
IP class	IP54
Weight	715 g
Temperature range	-20°C ~ +40°C

### High Bay Circular

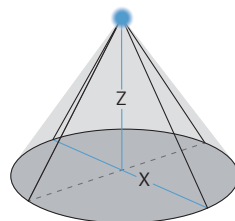

article nr.: LUM-DL02IQ-SNSR-PRHC

Diameter detection area high (14m)	Ø20 meters (X)
Diameter detection area low (4m)	Ø32 meters (X)
Maximum suspension height	14 meters (Z)
Minimum suspension height	4 meters (Z)

### High Bay Elliptical

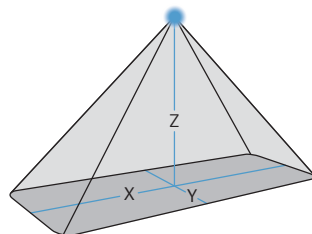

article nr.: LUM-DL02IQ-SNSR-PRHE

Length detection area low (4m)	10 meters (X)
Width detection area low (4m)	4 meters (Y)
Length detection area high (14m)	30 meters (X)
Width detection area high (14m)	4 meters (Y)
Maximum suspension height	14 meters (Z)
Minimum suspension height	4 meters (Z)

### Switching directions

Forward	→
Backward	←
Both	↔

### Sync / Solo

Synchronize sensors  
or switch areas  
individually

### Duration / light

5 sec-15 min	2-1000 lux
--------------	------------

### Standby mode

Available positions:  
-0% / Off  
-10%

## IQ TRONICS: PRESENCE DETECTION LOWBAY PIR SENSOR

- With this presence detector, the light switches on when presence is detected. This enables maximized power savings, without compromising the ease of use of the DATALUX light system.
- This Tronic can be integrated with DATALUX.IQ, DATALUX.LT and DATALUX.AC lighting systems.
- The switching direction of the sensor can be set separately, so one can choose to power one side constantly and the other side switching on the sensor.
- With the standby setting, you can choose to switch off lighting or reduce light output to 10% when no detection takes place. This setting can be set separately on both sides of the sensor.

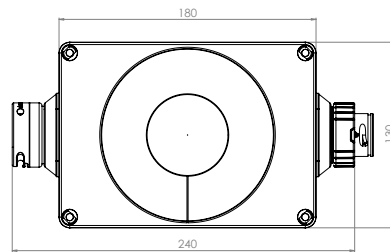

### Feature

Input voltage	220 - 240 V <sub>AC</sub> , 50/60 Hz
Input power	1 Watt
Type of sensor	PIR by Steinel
Suspension height	2-5 meters
Dimensions (lxwxh)	180 x 130 x 130 mm
Time interval	5 sec. - 15 min.
IP class	IP54
Weight	715 g
Temperature range	-20°C ~ +40°C

### Low Bay Circular

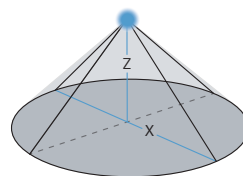

article nr.: LUM-DL02IQ-SNSR-PRLC

Diameter detection area high (5m)	Ø32 meters (X)
Diameter detection area low (2.5m)	Ø40 meters (X)
Maximum suspension height	5 meters (Z)
Minimum suspension height	2.5 meters (Z)

### Low Bay Elliptical

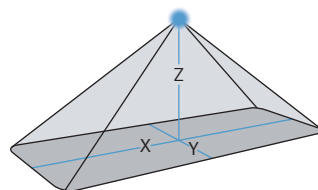

article nr.: LUM-DL02IQ-SNSR-PRLE

Length detection area low (2.5m)	20 meters (X)
Width detection area low (2.5m)	4 meters (Y)
Length detection area high (5m)	20 meters (X)
Width detection area high (5m)	4 meters (Y)
Maximum suspension height	5 meters (Z)
Minimum suspension height	2.5 meters (Z)

### Switching directions

Forward	→
Backward	←
Both	↔

### Sync / Solo

Synchronize sensors  
or switch areas  
individually

### Duration / light

5 sec-15 min	2-1000 lux
--------------	------------



### Standby mode

Available positions:  
-0% / Off  
-10%

All products, product specifications and data are subject to change without notice to improve reliability, safety, function, design or otherwise.