

INSTALL-TOOLS: STEEL WIRE SET SCREW MOUNT - SCREW ADJUSTER

- With these steel wire sets, all LUX series fixtures can be suspended under a ceiling construction.
- The plastic clamp LUM-LS00xx-CLMP-PP40 can be screwed on the threaded adjuster.
- The other side screws into the ceiling construction.
- No tools are required to adjust the suspension height.

Partnummers:

1. LUM-LS00xx-CBLE-TOP-MNTG
2. LUM-LS15xx-CBLE-150 (OF 300)
3. LUM-LS00xx-CBLE-GRIP-SNGL
4. LUM-NUTM6-0020-05



Application

Ceiling mounting
Fixture mounting

Screw
Thread for plastic clamp
LUM-LS00xx-CLMP-PP40

Features

Ceiling mount material
Cable material
Adjuster material
Maximum load per cable

Nickel-plated brass
Stainless steel
Nickel-plated brass
15 kg

Type

article no: LUM-LS15xx-CBLE-SMSA

Dimensions cable
Weight

1500 mm x 1.5 mm
33 g

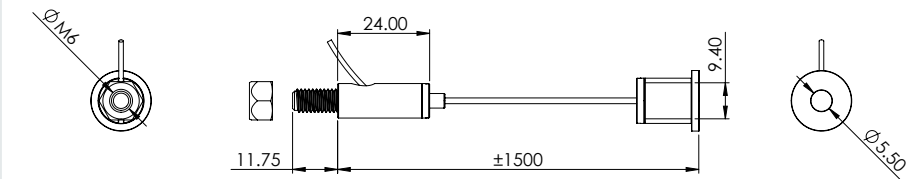

Type

article no: LUM-LS30xx-CBLE-SMSA

Dimensions cable
Weight

3000 mm x 1.5 mm
46 g

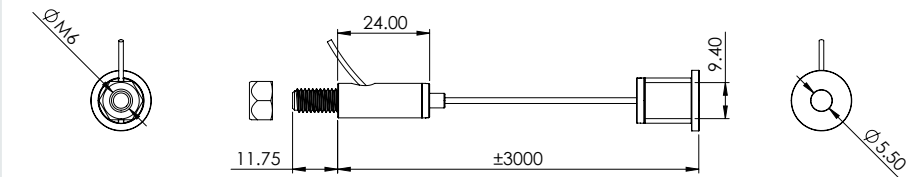

All products, product specifications and data are subject to change without notice to improve reliability, safety, function, design or otherwise.
The installer is responsible for proper installation of the fixture and its accessories.

INSTALL-TOOLS: STEEL WIRE SET SCREW MOUNT - HOOK ADJUSTER

- With these steel wire sets, all LUX series fixtures can be suspended under a ceiling construction.
- The metal clamp LUM-LS00xx-CLMP-SL40 can be mounted on the hook adjuster.
- The other side screws into the ceiling construction.
- No tools are required to adjust the suspension height.

Partnummers:

1. LUM-LS00xx-CBLE-TOP-MNTG
2. LUM-LS15xx-CBLE-150 (OF 300)
3. LUM-LS00xx-CBLE-GRIP-HOOK



Application

Ceiling mounting
Fixture mounting

Screw
Hook for metal clamp
LUM-LS00xx-CLMP-SL40

Features

Ceiling mount material
Cable material
Adjuster material
Hook material (bottom)
Maximum load per cable

Nickel-plated brass
Stainless steel
Nickel-plated brass
Nickel-plated steel
15 kg

Type

article no: LUM-LS15xx-CBLE-SMHA

Dimensions cable
Weight

1500 mm x 1.5 mm
37 g

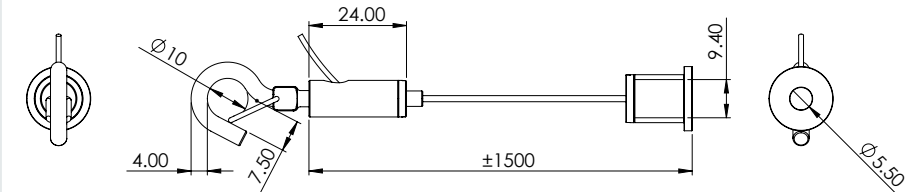

Type

article no: LUM-LS30xx-CBLE-SMHA

Dimensions cable
Weight

3000 mm x 1.5 mm
50 g

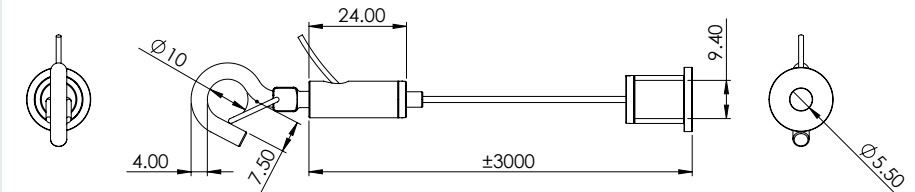

All products, product specifications and data are subject to change without notice to improve reliability, safety, function, design or otherwise.
The installer is responsible for proper installation of the fixture and its accessories.

INSTALL-TOOLS: STEEL WIRE SET HOOK MOUNT - SCREW ADJUSTER

- With these steel wire sets, all LUX series fixtures can be suspended under a ceiling construction.
- The plastic clamp LUM-LS00xx-CLMP-PP40 can be screwed on the threaded adjuster.
- The other side hooks into the ceiling construction or ceiling anchor.
- No tools are required to adjust the suspension height.

Partnummers:

1. LUM-LS15HK-CBLE-150
2. LUM-LS00xx-CBLE-GRIP-SNGL
3. LUM-NUTM6-0020-05



Application

Ceiling mounting	Hook (corrugated ceiling / ceiling anchor)
Fixture mounting	Thread for plastic clamp LUM-LS00xx-CLMP-PP40

Features

Ceiling mount material	Nickel-plated steel
Cable material	Stainless steel
Adjuster material	Nickel-plated brass
Maximum load per cable	15 kg

Type

article no: LUM-LS15xx-CBLE-HMSA

Dimensions cable 1500 mm x 1.5 mm

Weight 31 g

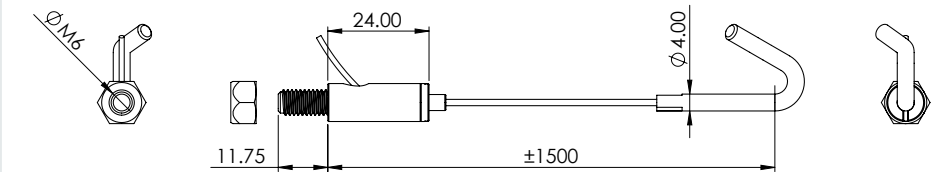

Mounting

Drill size ceiling plate	Ø7 mm
Recommended minimum cable length*	>=150 mm

All products, product specifications and data are subject to change without notice to improve reliability, safety, function, design or otherwise.

* With a shorter cable length, there is a greater chance that the hook will come loose in the event of an incident. Regardless of this advice, the installer always remains responsible for the proper installation of the fixture and its accessories.

INSTALL-TOOLS: STEEL WIRE SET HOOK MOUNT - HOOK ADJUSTER

- With these steel wire sets, all LUX series fixtures can be suspended under a ceiling construction.
- The metal clamp LUM-LS00xx-CLMP-SL40 can be mounted on the hook adjuster.
- The other side hooks into the ceiling construction or ceiling anchor.
- No tools are required to adjust the suspension height.

- Partnummers:
- 1. LUM-LS15HK-CBLE-150
- 2. LUM-LS00xx-CBLE-GRIP-HOOK



Application

Ceiling mounting	Hook (corrugated ceiling / ceiling anchor)
Fixture mounting	Hook for metal clamp LUM-LS00xx-CLMP-SL40

Features

Ceiling mount material	Nickel-plated steel
Cable material	Stainless steel
Adjuster material	Nickel-plated brass
Hook material (bottom)	Nickel-plated steel
Maximum load per cable	15 kg

Type

article no: LUM-LS15xx-CBLE-HMHA

Dimensions cable	1500 mm x 1.5 mm
Weight	35 g

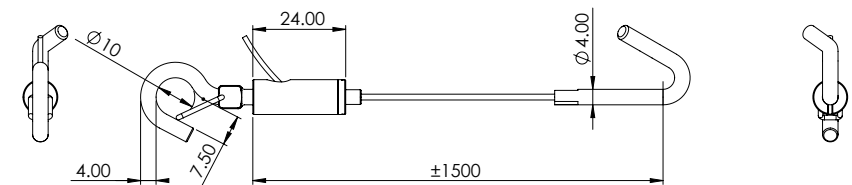

Mounting

Drill size ceiling plate	Ø7 mm
Recommended minimum cable length*	>=150 mm

All products, product specifications and data are subject to change without notice to improve reliability, safety, function, design or otherwise.

* With a shorter cable length, there is a greater chance that the hook will come loose in the event of an incident. Regardless of this advice, the installer always remains responsible for the proper installation of the fixture and its accessories.